

# ANNEX OF TYPE EXAMINATION

## CERTIFICATE

Nr.: LDsq08-0816-0154-22

**Description :** Devices to prevent falls referred to in point 3.2 of Annex I to prevent the car from falling or uncontrolled movements of Lifts Directive 2014/33/EU

**Application areas:**

- ✓ Electrical and Hydraulic Lifts

Data / Type	ÖBM-KF 04				
	ÖBM-KF 04-9	ÖBM-KF 04-16	ÖBM-KF 04-9	ÖBM-KF04-16	ÖBM-KF 04-16
Guide Rail Thickness (mm)	9	16	9	16	16
Rated Mass (kg) Max/Min (P+Q)	700 – 1750	700 – 2500	700 – 1400	700 – 2200	700 – 1900
Maximum tripping speed (m/sn)	1,50	1,50	2,15	2,15	2,62
Condition of Guide Rail Surface	Machined – Drawn	Machined – Drawn	Machined – Drawn	Machined – Drawn	Machined – Drawn
Lowest Width of Catching Surface(mm)	10	10	10	10	10
Type of oil	HLP 32, HLP 46	HLP 32, HLP 46	HLP 32, HLP 46	HLP 32, HLP 46	HLP 32, HLP 46
Serial Nr and Manufacture Year	Test Sample / 2022				

**Type of guide rails** T70/A, T82A, T89/A, T89/B, T90/A, T90/B, T114/B, T125/B

**Permissible thickness head of guide rails:** 16 mm, 9 mm

**Lowest Width of Catching Surface (mm):** 10 mm

**Oil Condition of guide rails :** oiled or non oiled

**Oil class and specifications:** HLP 32, HLP 46

**Declared electrical safety device informations:**

ELECTRICAL SAFETY DEVICE INFORMATION			
Type	CLS-103R		
Manufacturer	GLORIOUS	Number of Certificate /Test Report	SP1001GZ1912374
Current / Voltage lectricCurrent	250 VAC / 6 A, 220 VDC/ 0.3 A	Protection of ElectricalSafety Device	IP65

**Send Date of sample safety gears:** 03.08.2022

**Type Examination Date:** 10.08.2022

**Test Laboratory:** D KARE GÖZETİM TEST VE BELGELENDİRME TİC. LTD. ŞTİ.

**Conformity Assesment Standards :** EN 81-50:2020, EN 81-20:2020

The progressive Safety gear is also used as a braking device, together with the approved detection and triggering devices that are part of the uncontrolled car movement protection devices.

The type approval must be updated in case the design in the approved technical drawing is changed and / or a contact/switch other than the specified electrical contact/ switch is used. Typeexamination certificate can be used for products conforming to the information given in this annex.

**CEM ÇELİK**

**Technical Regulation Chief**

**Yayın Tarihi : 16 Ağustos 2022**

**Geçerlilik Tarihi: 15 Ağustos 2027**



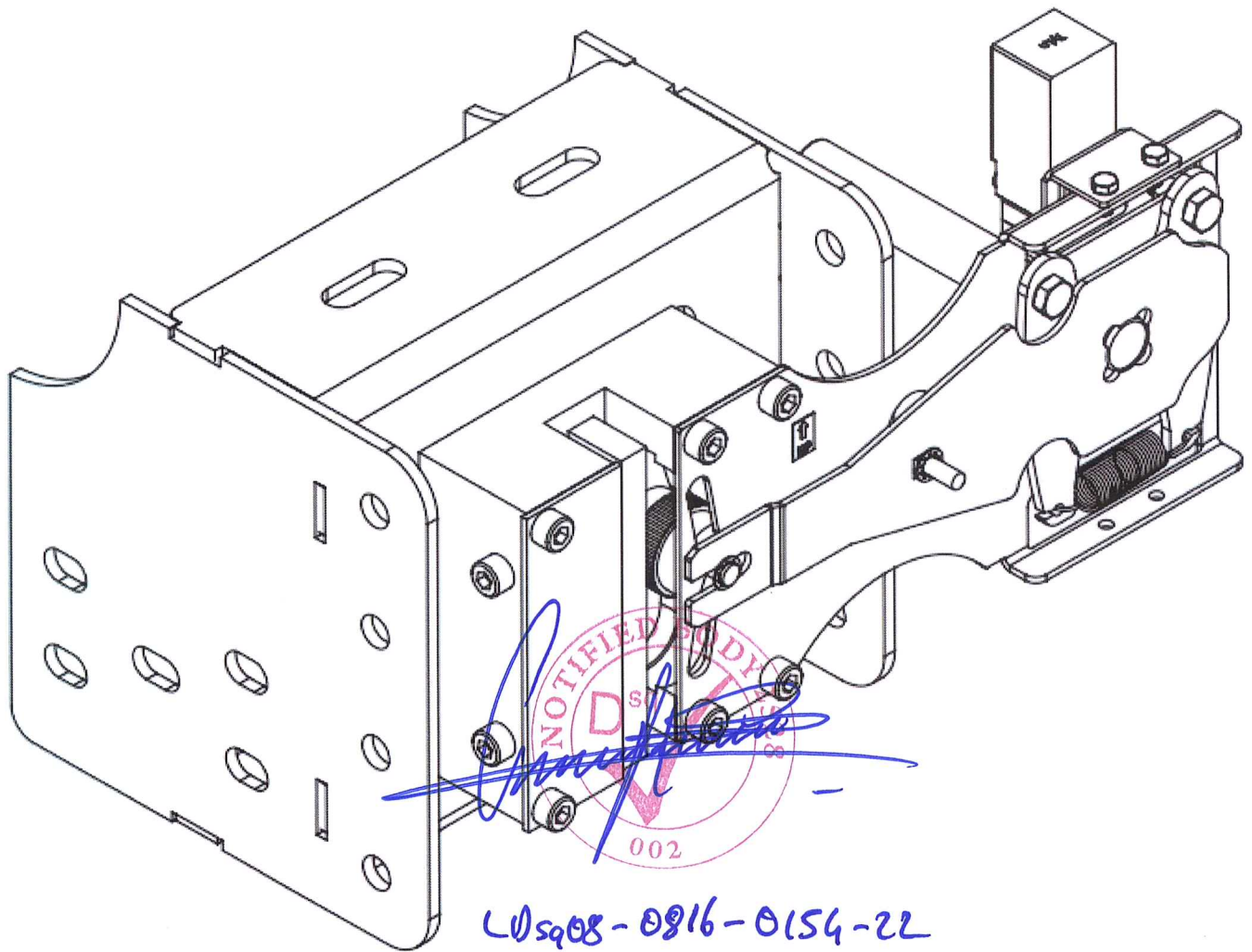

L0sq08-0816-0154-22

1.	Aktivasyon mili
2.	Mil yatağı
3.	Kol Burcu
4.	Aktivasyon Kolu
5.	Burc
6.	M8 Setskur
7.	M8X80 Cıvata
8.	Yay
9.	M8 Somun
10.	Güvenlik Swici
11.	M4X50 Cıvata
12.	M4 Somun
13.	Yay Laması
14.	Segman
15.	Gövde
16.	Makara
17.	Pölitretan
18.	Lama
19.	M8x15 Cıvata
20.	M8x45 Cıvata

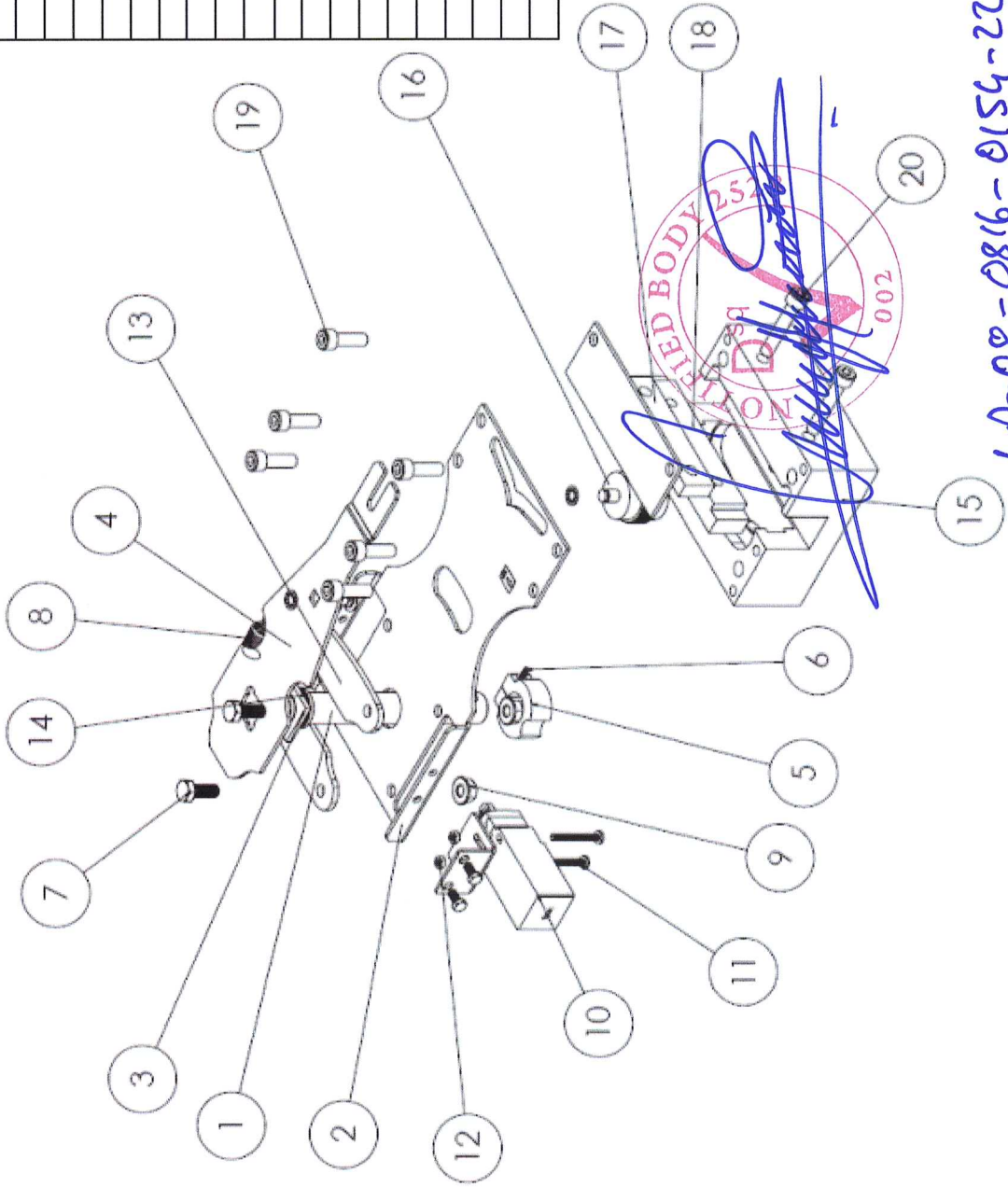

LDsp08-0816-0154-22